

Cor. & Distances.
 Down River
 57 1/2 E 94.3
 58. W. 68.
 524. W 164.
 326.3

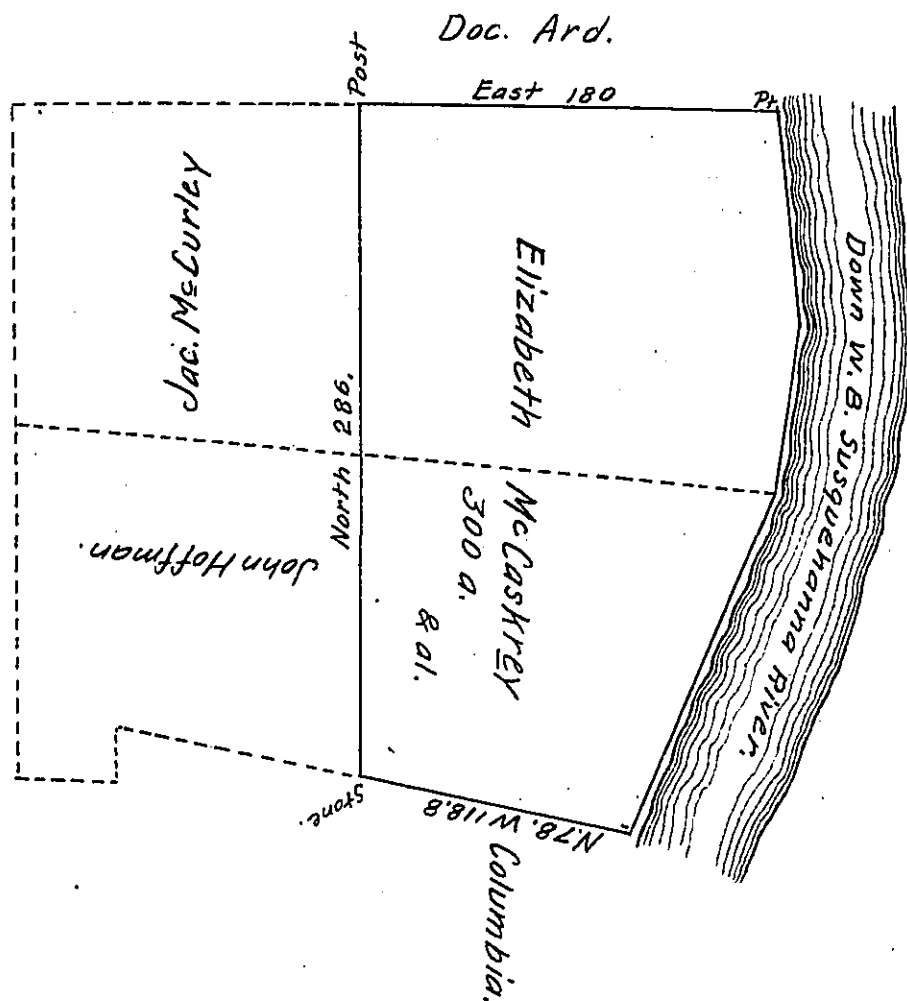

Situate in White Deer township, Union County. Surveyed the 10th. day of September AD. 1832, By virtue of an order dated 3d. day of April 1769. No. 1565 granted to Elizabeth McCaskrey. Containing three hundred acres with the usual allowance of Six per cent &c.
 Note. the above tract is parts of two tracts of land which was surveyed to John Zimmerman & Deterich Rees the 22 & 23d. days of October 1769 in pursuance of their orders viz. Zimmermans No. 14 & Rees No. — and now owned & occupied by Jacob McCurley, John Hoffman and others.

To Jacob Spangler Esq. per Jno. Hayes, Con.
 Surveyor General Penna.

IN TESTIMONY that the above is a copy of the original remaining on file in the Department of Internal Affairs of Pennsylvania, made conformably to an Act of Assembly approved the 16th day of February, 1833, I have hereunto set my Hand and caused the Seal of said Department to be affixed at Harrisburg, this eighth day of August 1908.

Henry H. ...
 Secretary of Internal Affairs.